

BI-FOLDING GATE KIT

Description

All items contained in the kit are made of galvanized steel and are specially designed swing gate bi-folding applications. The gates on which the kit is used can be motorized. The system allows for the gate folding parts to move simultaneously. Bifolding gate takes limited space when open.

Family of parts

KC7105

SCAN FOR MORE INFO

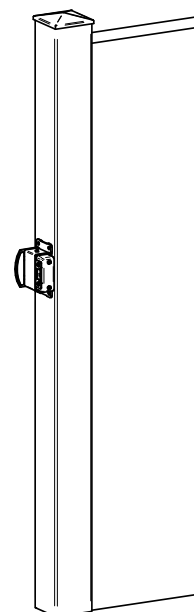
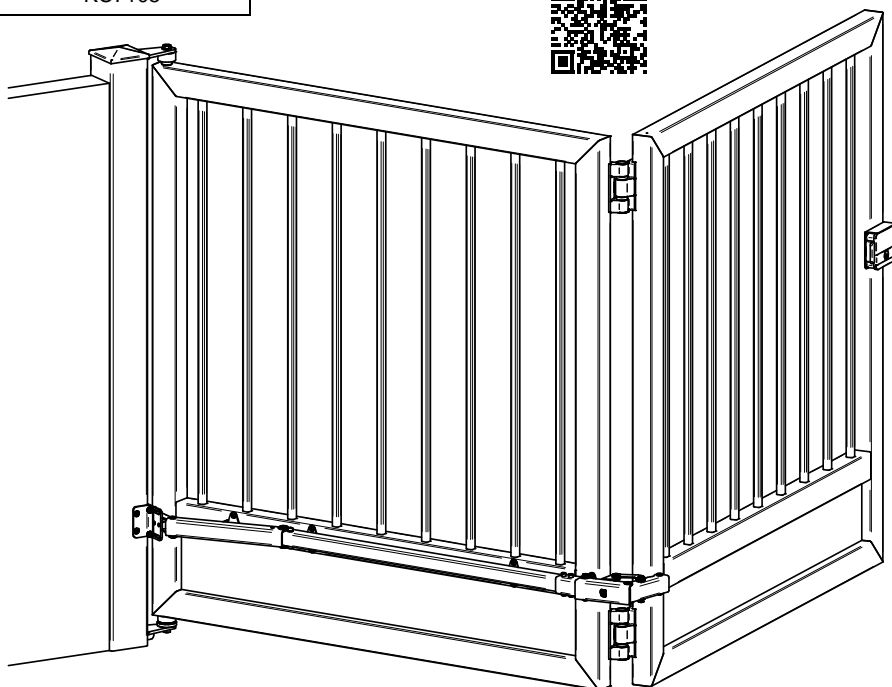

Component list

1x	1x	2x	2 x VC7105.060
<div>1</div>	<div>2</div>	<div>3</div>	<div>4</div>
C Profile 40x40x2 Optional VA5401.003/006	VC4111.B50 – VC4171.B50 Recommended	VC4212.B50-VC4272.B50 Recommended	

Install Kit on the leaf in workshop before the gate is erected (Pictures 1-11)

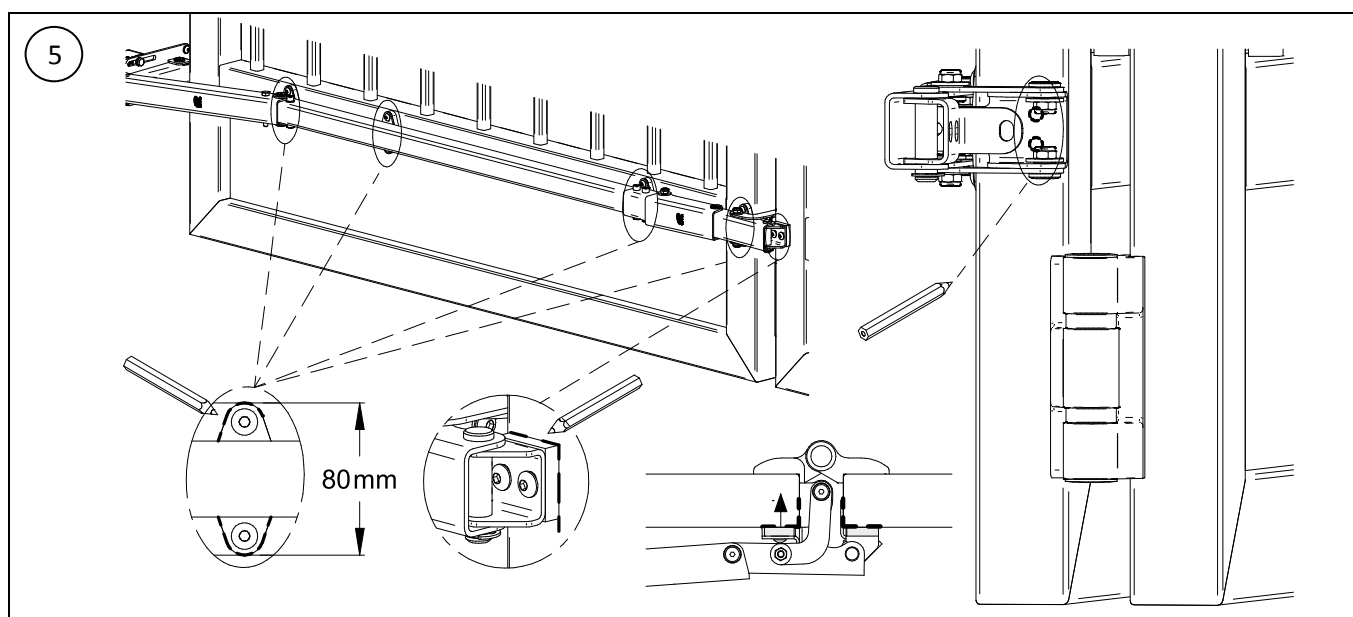
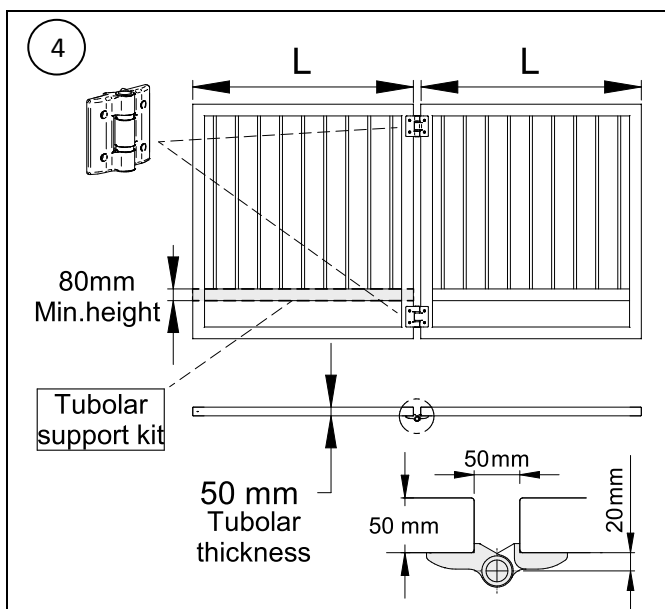
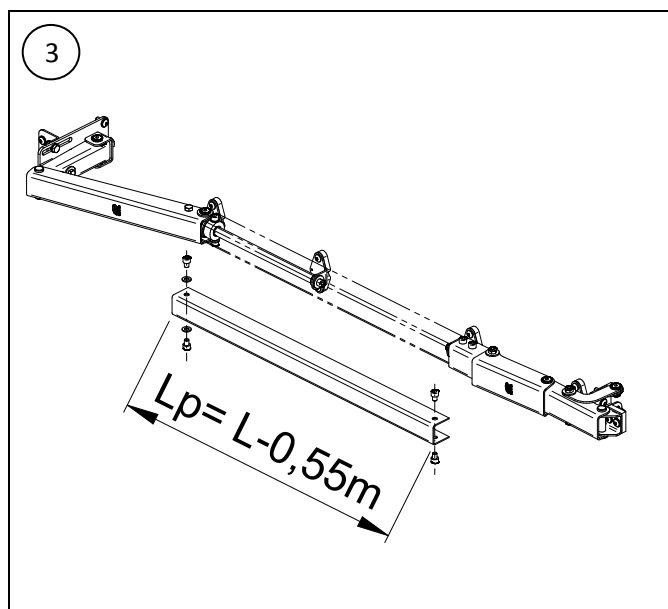
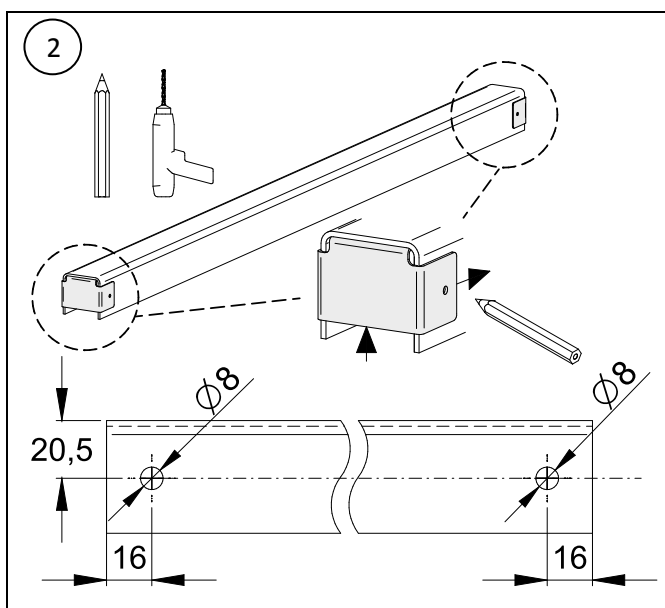
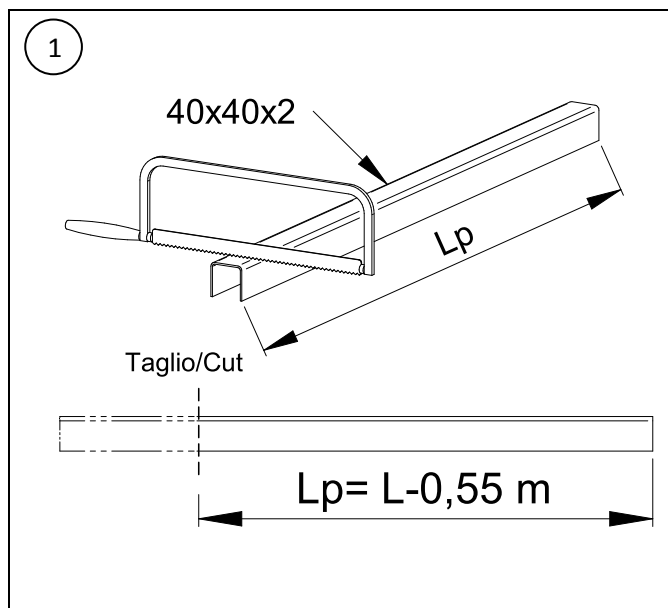

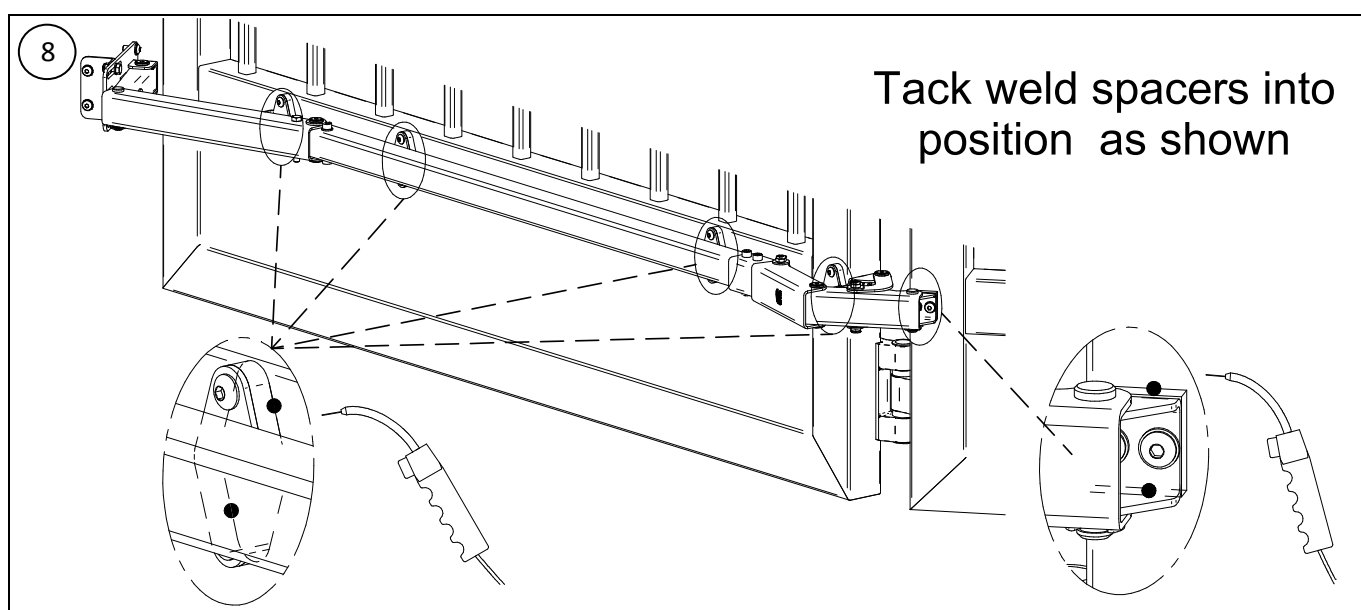
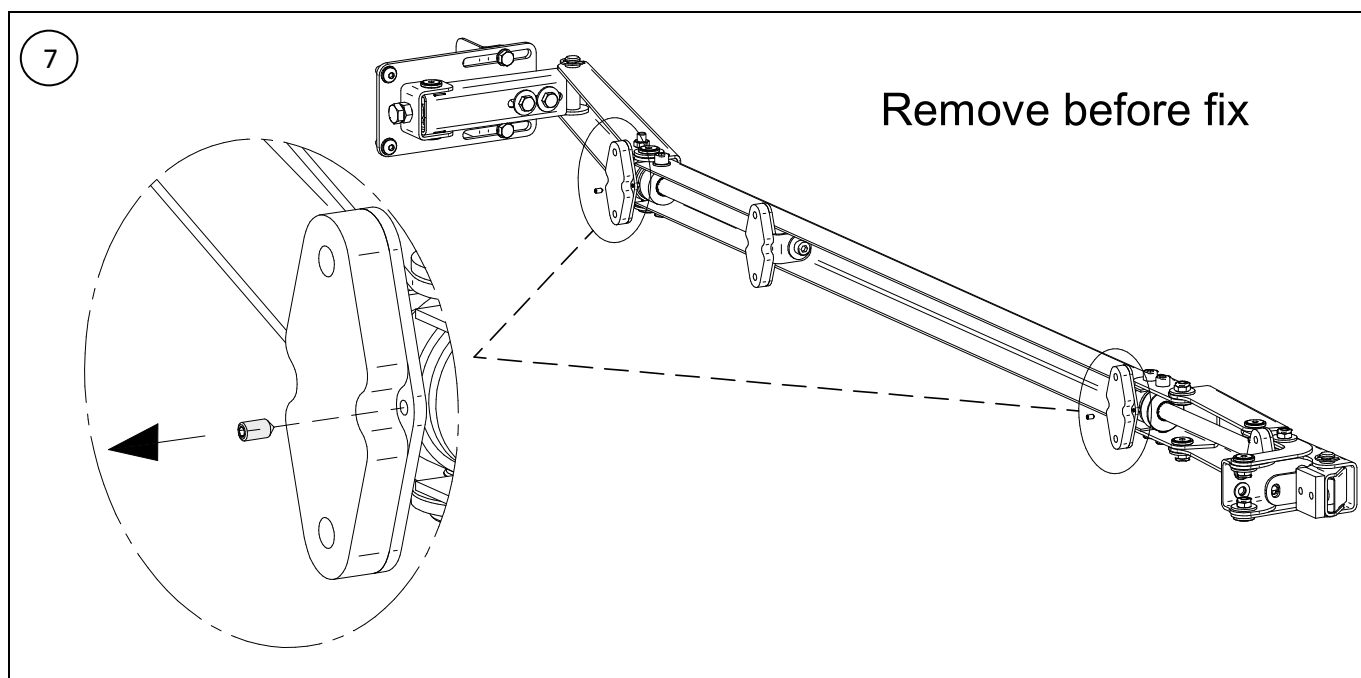
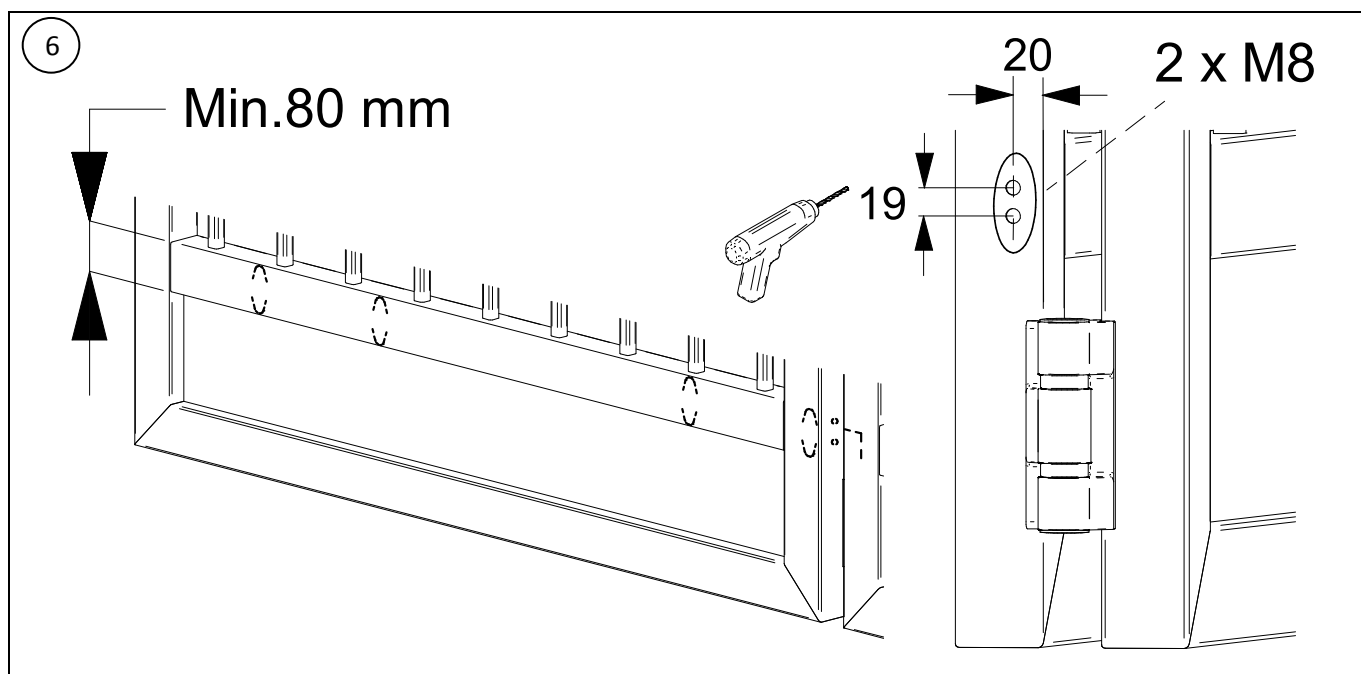

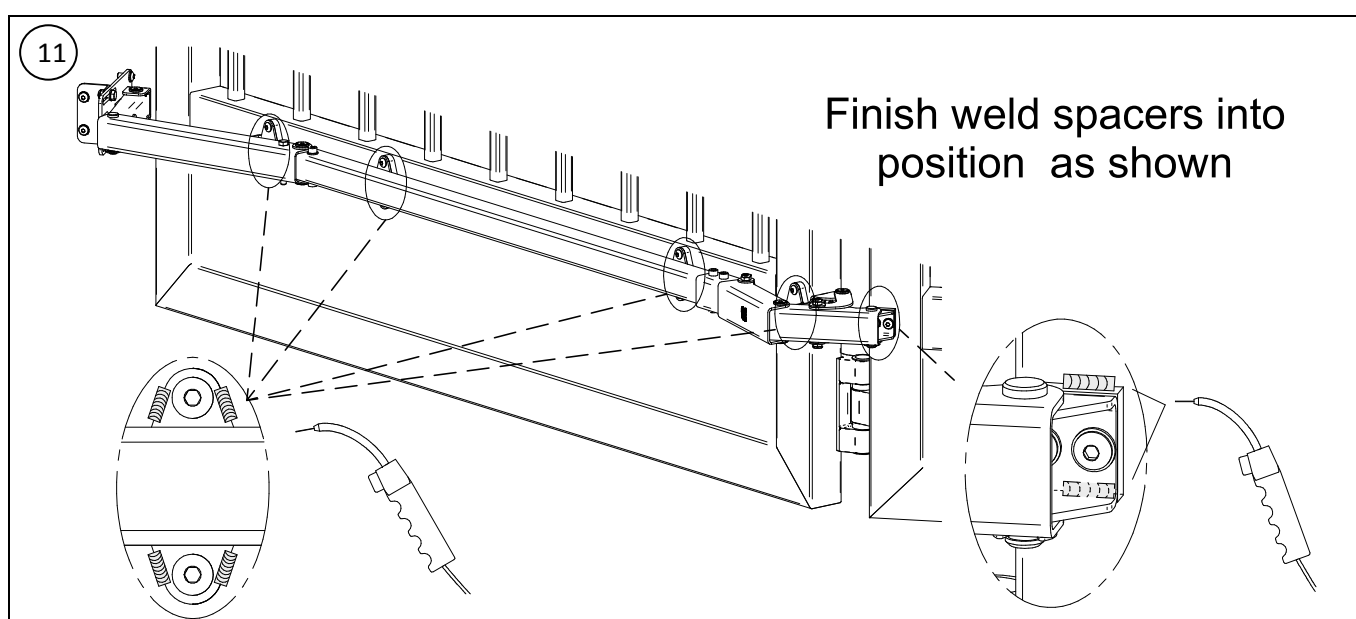
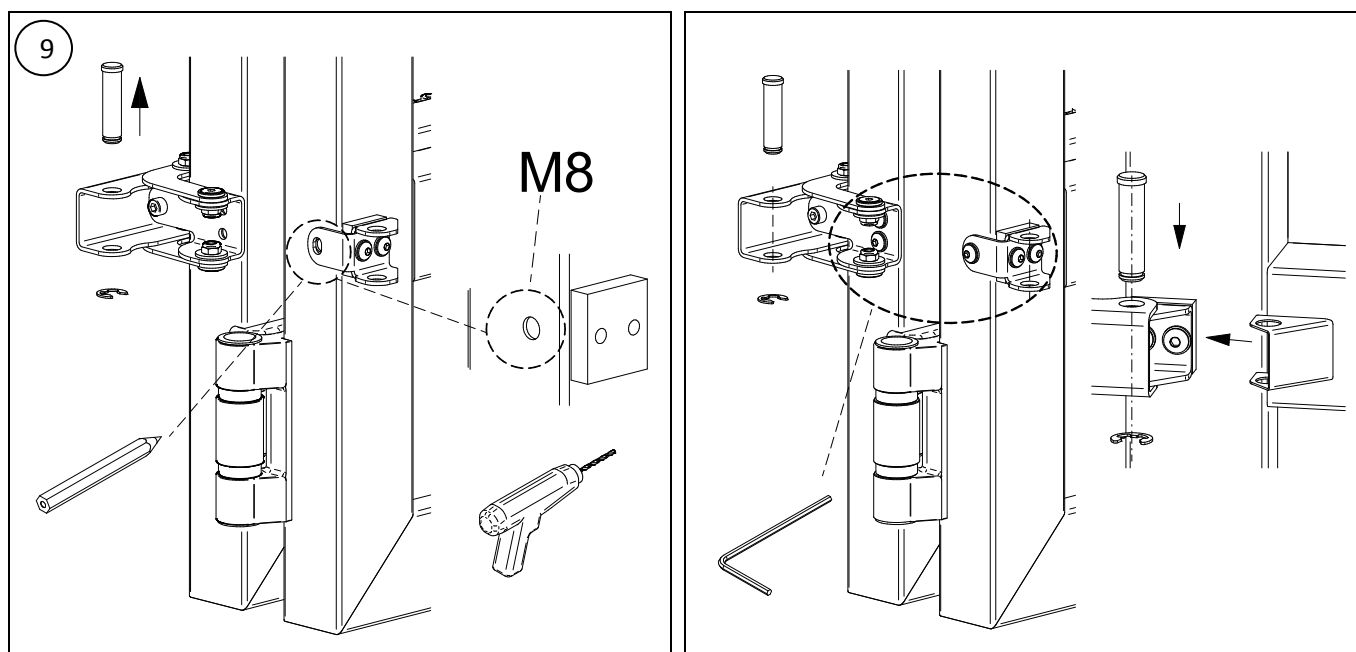

Operation to do before the gate is erected :

- Dismount the kit unscrewing the fixing screws
- If galvanization or paint is required protect all threaded holes
- Reinstall the kit
- Proceed from figure 12 with the installation of the kit and gate on site

15

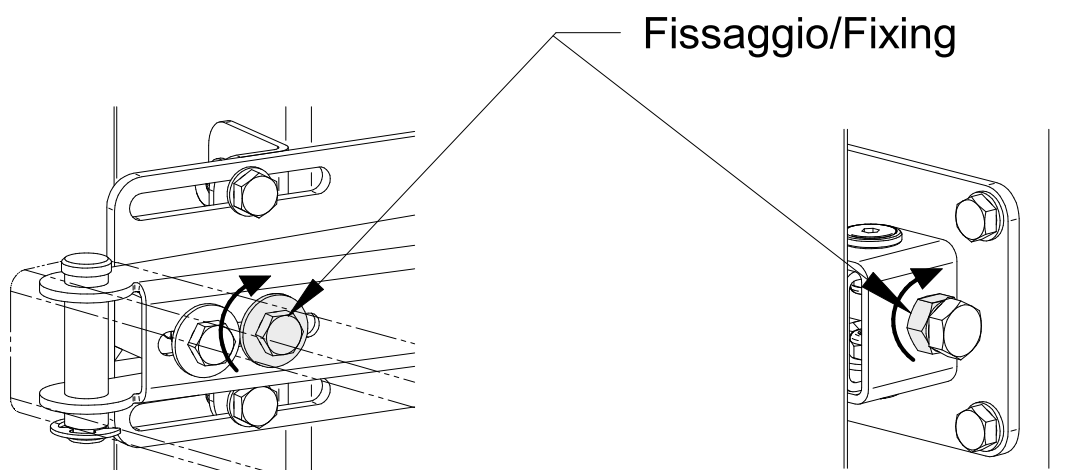

16

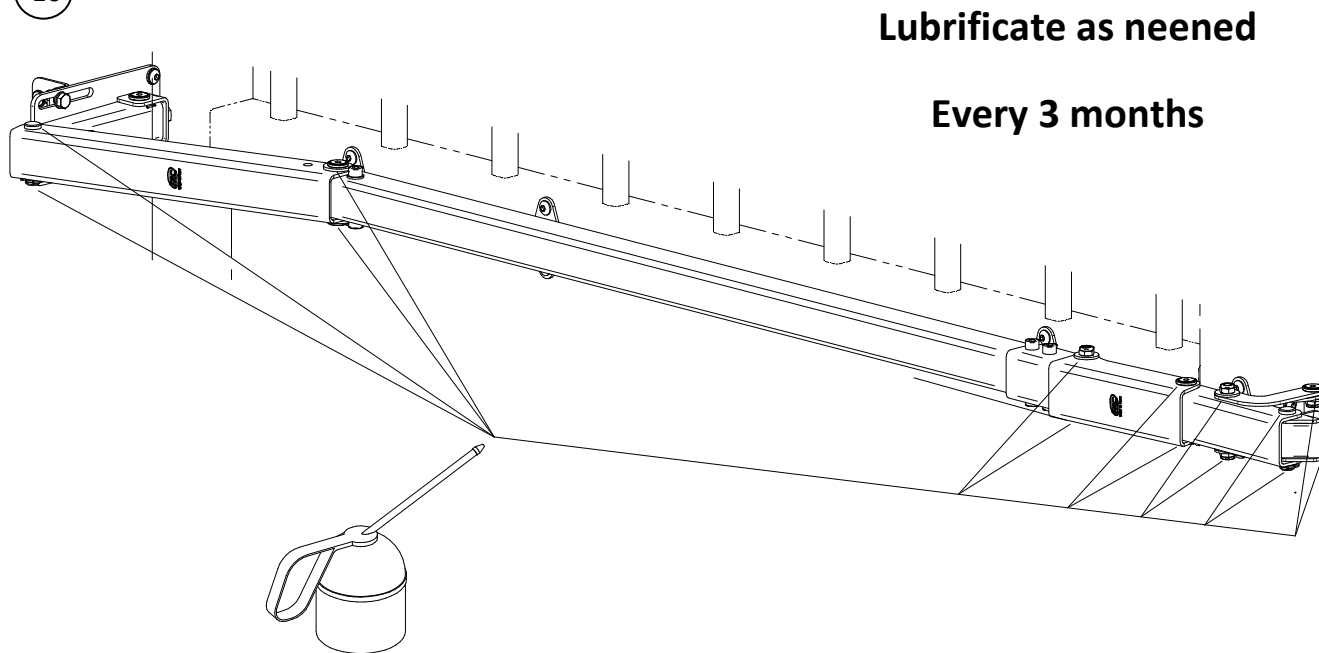

DIMENSIONING TABLE

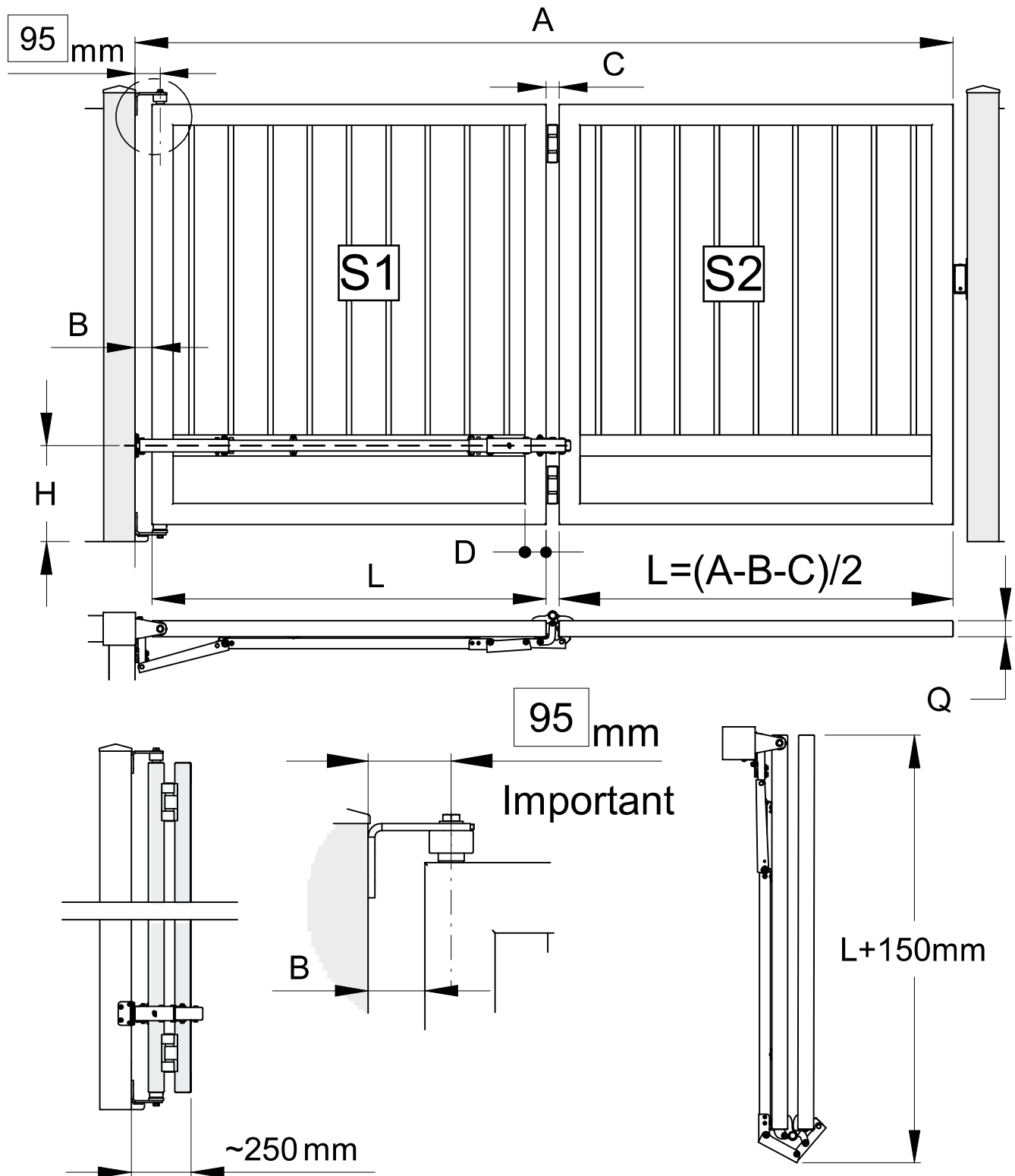

DIMENSION TABLE

A min-max [m]	B min [mm]	C [mm]	D [mm]	H	L min [m]	Q [mm]
1,9 - 5	65	50	Min.50	Near the Engine	0,89	50



Attention: installations that do not comply with the illustrated procedure or failure to carry out correct maintenance operations can cause the gate to fail and endanger the safety of persons and propriety

A[m]	L [m] with B=0,07	Max weight S2 [Kg]
2	0,94	205
2,5	1,19	170
3	1,44	145
3,5	1,69	120
4	1,94	105
4,5	2,19	95
5	2,44	85

Example dimensions not in table

A=2,8m

B=0,07m (min 0,065 m)

C=0,05m (da tabella sopra/from above table)

$$L=(A-B-C)/2$$

$$L=(2,8-0,07-0,05)/2$$

$$L=2,68/2$$

$$L=1,34 \text{ m}$$

Max S2 leaf weight according to the L lenght

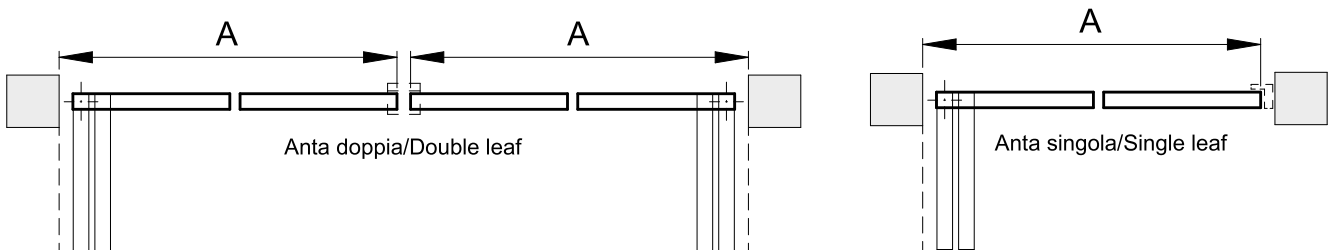

Important: If motorized set soft starts and stops to avoid elastic effects between the leaves

Maintenance

To maintain these parts in good and safe working conditions it is necessary to follow these steps:

1. After gate assembly is completed, perform a few manual opening and closing cycles, make sure there are no loose parts and periodically lubricate all bearings and junction points.
2. In case of accidental shock caused by moving vehicles or other external factors, check parts for external damages. In case of irreparable damage, replace with a new part. Always check the gate by manually opening a few opening and closing cycles. All maintenance procedures must be performed by trained technicians.
3. If the gate has any difficulty of movement or in presence of abnormal oscillations, the gate must be checked for worn parts and must be replaced if necessary. Gates working in harsh ambient conditions, such as; high humidity, salt, acids, dust or temperatures above 120°C will require special attention and frequent maintenance.
4. For motorized gates, pay special attention when selecting the operational speed. Soft starts and stops are highly recommended:
 - High speed of operation, and hard starts and stops may result in loosen nuts, bolts and irreparable damage.



Attention: installations that do not comply with the illustrated procedure or failure to carry out correct maintenance operations can cause the gate to fail and endanger the safety of persons and property